



BM-TV-1000 SPREADER PARTS LIST



SHANGHAI BOAMX ENGINEERING INC.

Address: Blvd.4 No.300 Youdong Rd, Shanghai, China, 201100

Tel: 86 21 54882951

Fax: 86 21 54882948

Website: www.bomaxengineering.com

E-mail: webmaster@bomaxengineering.com

Ver.01 2012

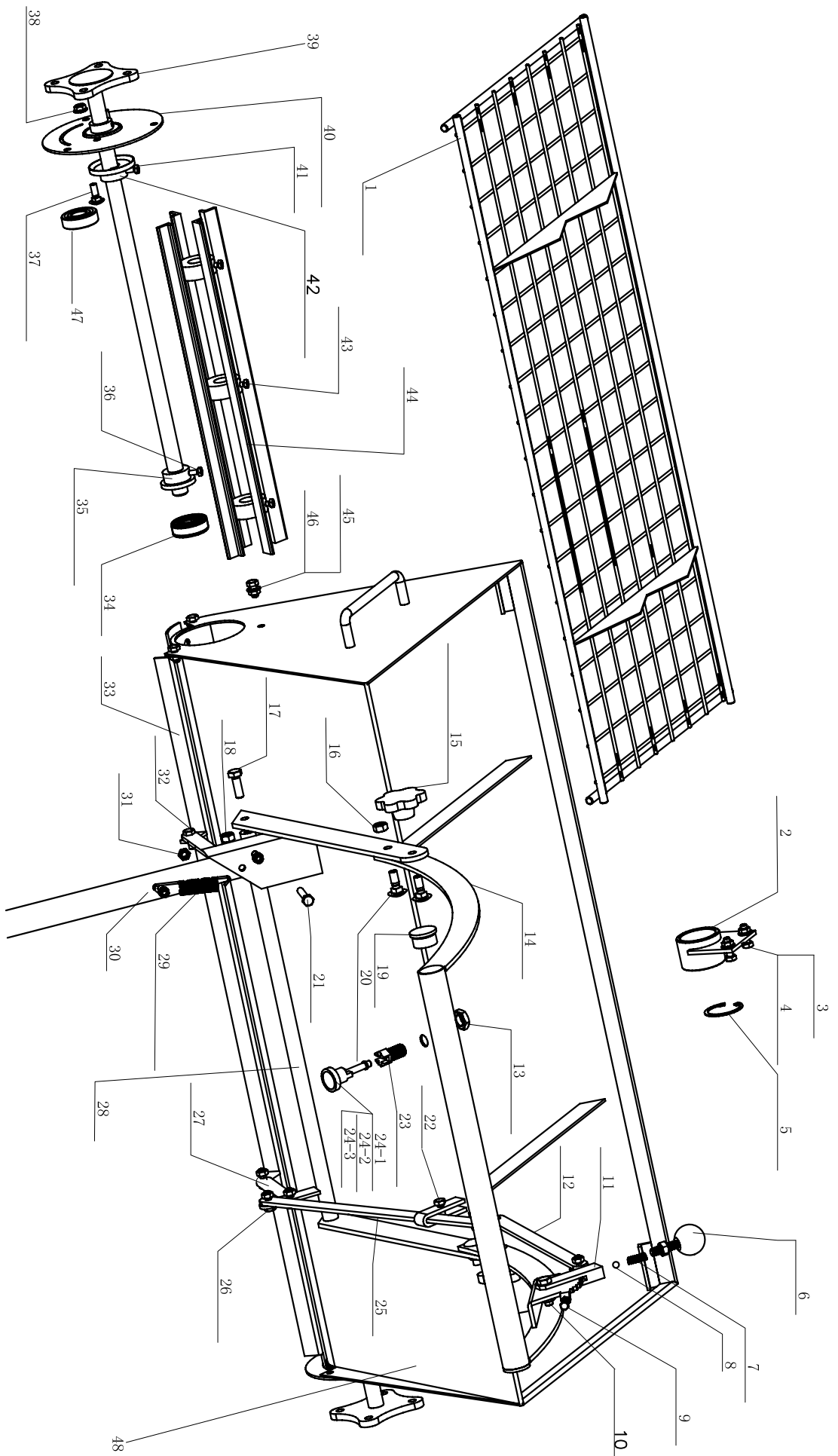

Ref No.	Parts No.	Description	QTY	Price (US\$) /pc
1	SM1000A4200	cover	1	
2	SM1000A1100	bearing base	1	
3	100-01-002Z	hex bolt	2	
4	100-22-002Z	hex nut	4	
5	100-26-004	spring washer	1	
6	103-03-001	M10 handle wheel	1	
7	100-52-004	spring washer	1	
8	107-01-001	steel ball	1	
9	100-01-016Z	hex bolt	1	
9	100-18-006Z	hex bolt	1	
10	100-01-011Z	hex bolt	10	
11	SM1000A2200	support of handle adjust	1	
12	SM1000A2006	connecter	1	
13	100-18-007Z	think nut	1	
14	SM1000A2100	handle	1	
15	103-03-003	M10 star knob	2	
16	100-20-002Z	self lock nut	3	
18	100-18-001Z	hex nut	2	
19	SM1000A2001	plug	2	
20	100-21-002Z	square bolt	4	
21	100-01-018Z	hex bolt	1	
22	100-01-006Z	hex bolt	7	
23	SM1000A4003	pin shell	1	
24-1	SM1000A4002	pin haed	1	
24-2	100-52-003	pin spring	1	
24-3	SM1000A4006	pin	1	
25	SM1000A2005	long connector	1	
26	100-20-003Z	self lock nut	6	
27	SM1000A2007	short connector	2	
28	SM1000A2300	barcket of rotal shaft	1	
29	100-52-005	spring	1	
30	SM1000A4100	foot	1	
31	100-20-003Z	self lock nut	1	
32	100-01-017Z	hex bolt	7	
33	SM1000A2400	plate	1	
34	100-38-001	bearing with rhombus base	2	
35	SM1000A1001	middle position plate	2	
37	100-21-001Z	squre bolt	4	
38	100-22-002Z	hex nut	8	
39	SM1000A1300	wheel shaft	2	
40	SM1000A1003	base plate of bearing	2	
41	100-01-015Z	hex bolt	4	
42	SM1000A1002	bearing pistion plate	2	
43	100-01-015Z	hex bolt	6	
44	SM1000A1200	rotate	2	
46	100-01-006Z	hex bolt	7	
48	SM1000A3100	body	1	
47	100-35-013	ball bearing	2	
49	100-47-004	wheel	2	